

# Site Plan - 1 Smith Street, Smithville

---

Aerial view of the site in question, tree location marked



Evergreen Ash to be removed



Evergreen Ash to be retained

---

Tree to be removed: Evergreen Ash (*Fraxinus Griffithii*)  
Replacement tree: Silver Stringy Bark

# Site Plan



BE ROAD

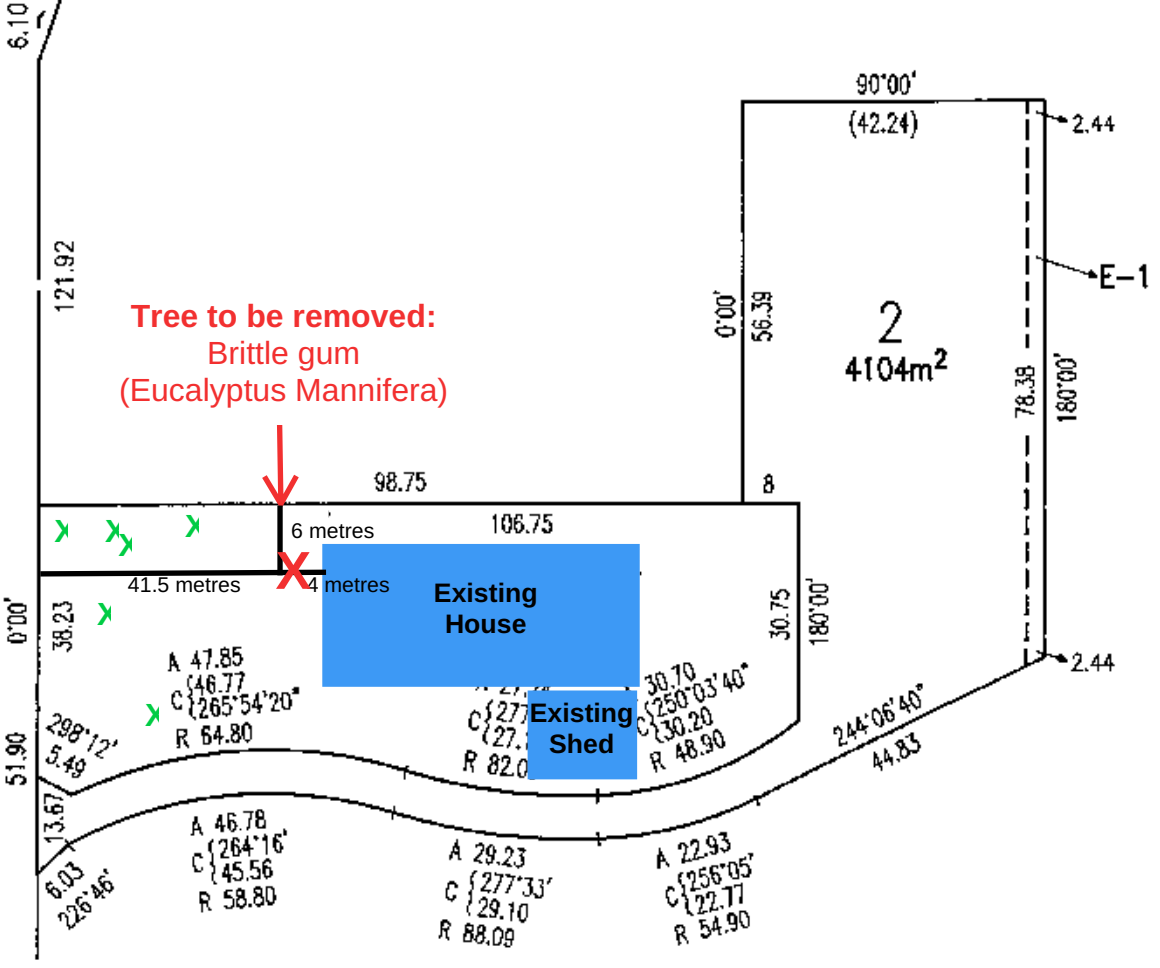

**X - Existing gums to be retained**

ORIGINAL	
SCALE	SHEET SIZE
1-750	A3
SCALE	
7.50 0 7.50 15 22.5 30 37.5	
LENGTHS ARE IN METRES	

Site: 1/2 Be Road,  
Beeville.

Sheet 2 of 2 sheets
Original sheet size A3

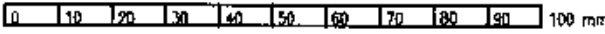

Site plan - 3 See Street, Seaville

